

capri

BY FRASER
hotel residences

BRISBANE / AUSTRALIA



CAPRI BY FRASER, BRISBANE

CONFERENCE & EVENTS KIT

ABOUT US

An effortlessly stylish and vibrant hotel residence designed by Award-winning Ministry of Design, Capri by Fraser, Brisbane bring a touch of an urban rainforest featuring living vertical gardens in the lobby and restaurant.

Centrally located in the heart of Brisbane CBD we are a short stroll to the City Botanic Gardens, Queen Street Shopping Precinct and Eagle Street Pier nightlife making us ideally positioned for business and leisure events.

AS A MODERN INTUITIVE HOTEL, WE OFFER:

- Three function rooms that cater for events from 4 to 120 attendees
- 239 vibrant premium hotel rooms
- Blackfire Mediterranean restaurant and bar
- 24-hour front desk and
- Heated indoor pool, sauna, and steam room
- 24-hour modern and large fitness centre
- 24/7 'Spin & Play' complimentary laundry facilities

VENUE + ACCOMMODATION

Capri by Fraser, Brisbane offers the facilities of a smart hotel with the comfort and convenience of your own space.

Well-equipped for all types of meetings and events, the hotel offers three thoughtfully designed event spaces The Pod, Pow Wow 1 and Pow Wow 2 which are complete with the latest integrated audio-visual capabilities and free WIFI.

Along with our three conference spaces we have 239 premium hotel rooms with your choice of Studio Deluxe, Studio Executive, Studio Premier and One Bedroom Apartments. All rooms are designed to welcome your guests in style and comfort

V E N U E

Located on Level One, the three function rooms each provide a unique event space with a colourful and bright feel. Our catering partner 'The Fresh Collective' have curated a modern Australian menu inspired by sustainability, local produce and seasonal ingredients which will be sure to delight and impress.



THE POD

The Pod is our largest, most versatile space showcasing an abundance of natural light and reflective gold ceiling. The space includes modern data projector, screen and internal sound system.



POW WOW 1

Pow Wow 1 features natural light with two large LCD TV screens making it a flexible space catering for both business meetings and intimate social events.



POW WOW 2

Pow Wow 2 is ideal for small boardroom meetings, featuring a wall mounted LCD screen and writeable glass wall panels.

VENUE

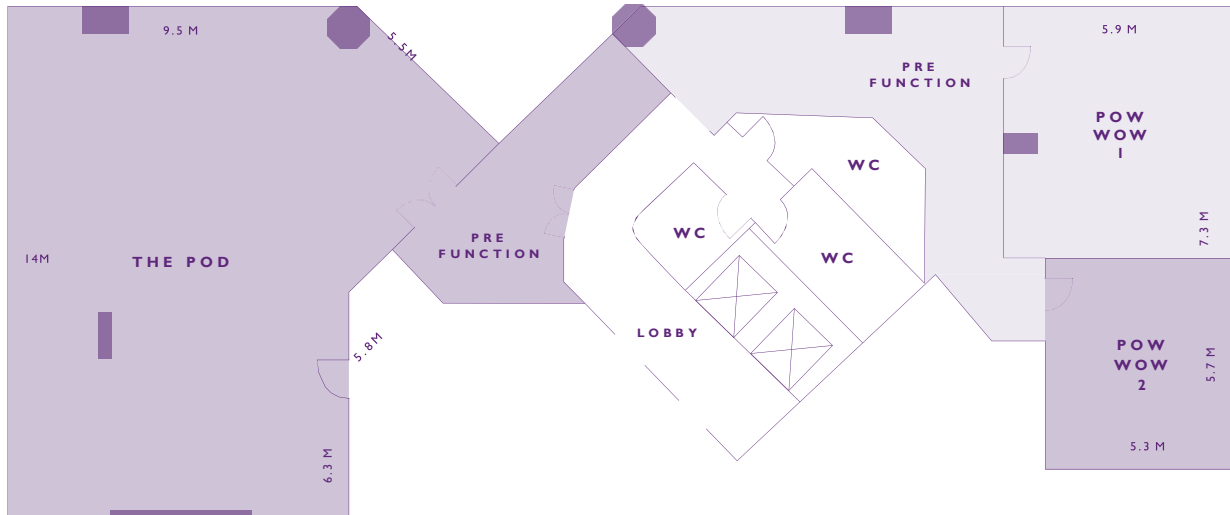

ROOM CAPACITY

	THE POD	POW WOW 1	POW WOW 2
AREA (M2)	162	45	33
CABARET	63	21	14
CLUSTER	64	25	16
BANQUET	81	27	15
CLASSROOM	63	18	18
U-SHAPE	36	21	15
BOARDROOM	30	18	12
THEATRE	100	35	25
COCKTAIL	120	40	30

CONFERENCE & EVENTS

ALL CONFERENCE PACKAGES INCLUDE:
NOTEPADS, PENS, WATER + WIFI

BREAKFAST

Minimum 10 pax

PLATED BREAKFAST

T2 Tea, Nespresso Coffee

1 X hot plated item (served individually to all guests), seasonal fruit & pastries pre-set on table to share.

ALT DROP PLATED BREAKFAST

T2 Tea, Nespresso Coffee

2 X hot plated item (served alternate drop to all guests), seasonal fruit & pastries pre-set on table to share.

STAND UP BREAKFAST

T2 Tea, Nespresso Coffee

Choice of 1 package breakfast package, delivered on platters for a cocktail or buffet style event.



BREAKFAST ADDITIONS

Hot breakfast addition

Light Pastries Addition

Additional price available upon request

DAY DELEGATE PACKAGES

Minimum 10 pax

ALL CONFERENCE PACKAGES INCLUDE: N
OTEPADS, PENS, WATER + WIFI

FULLDAY DELEGATE PACKAGE

T2 Tea
+ *Nespresso Coffee*
Morning Tea
2 x break items
Working Lunch
Subject to daily menu
Fruit juice
Afternoon Tea
2 x break items

MORNING / AFTERNOON TEA

Morning Tea OR Afternoon Tea
2 x break items

HALFDAY DELEGATE PACKAGE

T2 Tea
+ *Nespresso Coffee*
Morning Tea OR
Afternoon Tea
2 x break items
Working Lunch Subject
to daily menu
Fruit juice

MORNING / AFTERNOON TEA PACKAGE

T2 Tea
+ *Nespresso Coffee*
Morning Tea OR Afternoon
Tea
2 x break items

D E L U X E P A C K A G E S

M i n i m u m 2 0 p a x

ALL CONFERENCE PACKAGES INCLUDE:
NOTEPADS, PENS, WATER + WIFI

DELUXE FULL DAY DELEGATE PACKAGE

T2 Tea
+ *Nespresso Coffee*

Morning Tea
2 x break items

Working Lunch
Choice of 1 hot item with
2 sides
Fruit juice

Afternoon Tea
2 x break items

DELUXE HALF DAY DELEGATE PACKAGE

T2 Tea
+ *Nespresso Coffee*

Morning Tea OR
Afternoon Tea
2 x break items

Working Lunch
Choice of 1 hot item with 2
sides

Fruit juice

DELUXE WORKING LUNCH PACKAGE

Working Hot Lunch
Choice of 1 hot item with
2 sides
Fruit juice

LUNCH PACKAGES

Minimum 10 pax

ALL CONFERENCE PACKAGES INCLUDE:
NOTEPADS, PENS, WATER + WIFI

LIGHT LUNCH PACKAGE

Chef's selection of
2 x Gourmet Sandwiches
2 x daily salads

Fruit juice

DAILY BUFFET LUNCH PACKAGE

Set weekday hot

buffet meals

Fruit juice

COCKTAIL EVENT

MINIMUM 20 pax

NETWORKING CANAPE PACKAGE

- 1 x hot item
- 1 x cold item
- 1 x Sweet

4 PIECE CANAPE PACKAGE

- 2 x hot items
- 2 x cold items

5 PIECE CANAPE PACKAGE

- 3 x hot items
- 2 x cold items

6 PIECE CANAPE PACKAGE

- 3 x hot items
- 3 x cold items



SUBSTANTIAL ADDITIONS

As an addition to a package-
not a standalone item

CANAPE PLATTER

- 20 x Heirloom beet & goats cheese tart, crispy leeks (gf,v/nf)
- 20 x Fajita chicken, crispy taco cup, coriander, lime, smoked sour cream (nf)
- 20 x Pork & prosciutto roulade, fig gel, cranberry pearls, toasted buckwheat (gf,df,nf)

P L A T T E R S

S E R V E S 1 0



FRUIT PLATTER

— A selection of seasonal fresh fruits, sliced & presented beautifully on a platter

TRIO OF DIPS

— Trio of dips, toasted turkish and crudite

ANTIPASTO PLATTER

– Antipasto platter of cured meats, pickled and marinated vegetables and crackers

ARTISAN CHEESE PLATTER

– Artisan Cheese plate with quince paste, crackers and olives GF on request

HOT FOOD PLATTER

– Skewer Platter - Tandoori Chicken skewer with date and tamarind yoghurt (x15), Lamb Kofta with smoked Tzatziki (x15)

PARTY PLATTER

– Smoked Cheddar & Crispy Bacon Sausage rolls, Beef & Red Wine Petite Pies, Vegetarian mini quiche with tomato relish, (30pcs in total)

VEGAN PLATTER

– Pumpkin & Chickpea Rolls & Ratatouille & Herb Pesto Tarts and Pea, Mint and preserved lemon arancini – GF, (30pcs in total)

DINNER EVENT PACKAGES

SHARED DINING

Shared Dining with Dessert Canape

Shared Dining with Plated Dessert

Served family-style in the middle of the table for guests to help themselves or buffet style

Minimum 20 pax

DINNER INCLUDES

Choices of 2 Shared Dining Menu Options



FINE DINING

Minimum 20 pax

Mains only

Main only, Selection of two from main course menu, served alternate drop

Two courses with alternate drop

Entree & Main or Main & Dessert. Selection of two from each chosen menu, served alternate drop

Three courses with alternate drop

Entree, Main & Dessert. Selection of two from each menu, served alternate drop

PRICE AVAILABLE VIA QUOTES ONLY

BEVERAGES

HOUSE BEVERAGE PACKAGE

1 HOUR

2 HOUR

3 HOUR

4 HOUR

INCLUSIONS

Bay of Stones Sauvignon
Blanc
Bay of Stones Sparkling
Bay of Stones Shiraz
Bay of Stone Chardonnay
Peroni Nastro 3.5
Peroni Nastro Azzurro
Soft Drink
T2 Tea & Nespresso Pod
Coffee Station

DELUXE BEVERAGE PACKAGE

1 HOUR

2 HOUR

3 HOUR

4 HOUR

INCLUSIONS

Bay of Stones Sauvignon
Blanc
Bay of Stones Sparkling
Bay of Stones Shiraz
Bay of stone Chardonnay
Peroni Nastro 3.5
Peroni Nastro Azzurro
Stone & Wood Pacific Ale
Corona Extra
Soft Drink
T2 Tea & Nespresso Pod
Coffee Station

PREMIUM BEVERAGE PACKAGE

1 HOUR

2 HOUR

3 HOUR

4 HOUR

INCLUSIONS

Chandon NV Sparkling Brut
Wither Hills Sauvignon Blanc
St Hallet 'Black Clay' Shiraz
Stoneleigh 'Rapura' Pinot Noir
Peroni Nastro 3.5
Peroni Nastro Azzurro
Stone & Wood Pacific Ale
Corona Extra
Soft Drink
T2 Tea & Nespresso Pod Coffee
Station

BEVERAGES

NON – ALCOHOLIC PACKAGE

INCLUSIONS:

Soft drink
Fruit Juice
T2 tea & Nespresso Coffee

BEVERAGE ON CONSUMPTION

MINIMUMS SPEND

INCLUSIONS:

Soft drinks
Bay of Stone Sparkling
Bay of stone Shiraz
Bay of Stone Sauvignon Blanc
Bay of Stone Chardonnay
Stone & wood Pacific Ale
Corona Extra
Personi Nastro Azzurro
Personi Nastro 3.5

ACCOMMODATION

Each of our hotel accommodation rooms have been thoughtfully designed with a colourful palette focusing on comfort and convenience. Each room includes complimentary WIFI, king bed, and large working desk with ergonomically designed Herman Miller chairs.

The Studio rooms contain kitchenettes with pod coffee machines, microwave, sink and mini bar fridge, while the One Bedroom Apartments offers full kitchen cooking facilities and in-room washer/dryer with separate living and bedroom spaces.



STUDIO DELUXE

25sqm with kitchenette



STUDIO EXECUTIVE

28sqm with kitchenette + Wallaby Water Cans



STUDIO PREMIER

32sqm with kitchenette + City or Botanic garden views + Voss Water bottles



ONE BEDROOM APARTMENT

45-55sqm with kitchenette + separate lounge

FACILITIES

Offering the modern leisure facilities including indoor heated pool, fully equipped gym, steam room, sauna and 24/7 Spin & Play laundry, guests are sure to enjoy their stay whether they are visiting for business or leisure.



C O N T A C T U S

Please contact our friendly team via sales.brisbane@capribyfraser.com or 07 3013 0064.

We look forward to hosting your next event.



Capri by Fraser, Brisbane 80
Albert Street Brisbane
City Queensland 4000